

berbel
aero performance

berbel

Built-in Hoods BEH 60/90 FL/FLT

Operating Instructions



03/2010

English version of original German instructions

These instructions help you to use our product properly, safely and economically. In the following text, our berbel built-in hoods BEH 60 FL/FLT and BEH 90 FL/FLT product is briefly referred to as device.

These instructions are intended for the following persons:

- Persons who use the device
- Persons who clean the device
- Persons who dispose of the device.

Each of these persons must have read and understood the contents of these instructions.

Compliance with these instructions helps to avoid dangers and to increase the reliability and service life of the device.

Structural features in the text

Defined structural features are assigned to the elements contained in these instructions. A distinction can therefore be easily made between the following elements:

Normal text

Cross references

- Lists or

➤ Action steps.

- ① Tips contain special information on the economical use of the device.

Structural features in illustrations

The illustrations contain portrayals in various grey scales. Movements which are to be carried out are made clear using movement or direction arrows. If several action steps are portrayed in one illustration, the sequence is made clear using numbers (1., 2., ...):

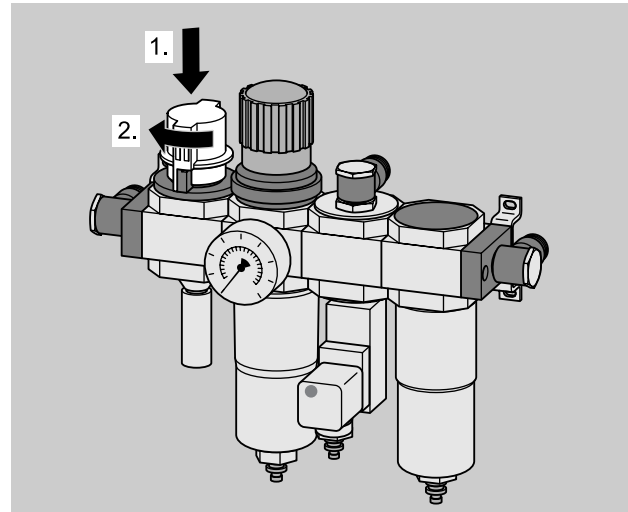

If reference is made to elements in a legend or in the body text, these are provided with an item number (2):

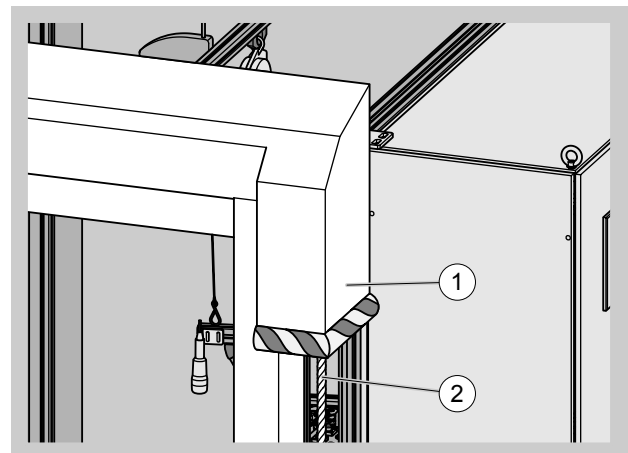

Table of contents

Safety	5
Proper use	5
Ban on independent conversions and modifications	5
Basic safety instructions	5
Structural features of the information on dangers	7
Structural features of notices regarding material or environmental damage.....	7
 Description	 8
Possible operating modes	8
View of the device with flap closed	10
View of the device with flap open	11
 Operation with the button panel	 12
Switching on the ventilation function	12
Changing the output level	13
Switching off the ventilation function	14
Switching the run-on function on and off	14
Switching the lighting on and off	14
Using the extension	15
 Operation with the Sensor-Touch control panel	 16
Switching on the ventilation function	16
Changing the output level.....	17
Switching off the ventilation function	17
Switching the run-on function on and off	17
Switching the lighting on and off.....	17
Displays	17
Carrying out settings.....	18
 Cleaning	 20
Cleaning intervals	20
Cleaning in the case of normal soiling.....	20
Cleaning in the case of severe soiling	20
Cleaning surfaces	23
 Maintenance	 24
Maintaining the device	24
Replacing the lighting	24
Replacing the filter filling (hybrid and recirculating air filters)	24
 Rectifying malfunctions	 27

Disposal	29
Disposing of packaging.....	29
deviceDisposal.....	29
Technical data	30
Model plate	30
Built-in hood BEH 60 FL/FLT.....	30
Built-in hood BEH 90 FL/FLT.....	30
Contacting the manufacturer	31

Safety

Read through this chapter carefully before installing, using or cleaning the device.

- Observe all information on dangers during all activities on the device.
- Enclose these instructions if you pass the device on.

Proper use

The device can be used to extract cooking vapours during cooking.

The device is exclusively intended for this purpose and must only be put to this use. The device must only be used in the manner described in these instructions.

Any other use or modification of the device is regarded as improper and may lead to damage.

The manufacturer accepts no liability for damage caused as a result of improper use, incorrect installation or incorrect operation. The device is not intended for commercial use. Use the device in private kitchens only.

Ban on independent conversions and modifications

- Do not undertake any independent conversions or modifications on the device. Conversions or modifications without the approval of berbel Ablufttechnik GmbH are impermissible.
- Never bridge or bypass the protective facilities available on the device.

Basic safety instructions

This section contains basic safety instructions for handling the device. Additional safety instructions which affect certain actions and procedures can be found in the relevant chapters.

- Heed all of the safety instructions and information on dangers in these instructions.
- Check the device and all parts for visible damage. In the event of damage, contact your specialist dealer or the berbel customer service. The device must only be used in flawless condition.
- Always have repair and maintenance work carried out by qualified, specialist personnel. Otherwise, you endanger yourself and others.
- Install the device with the enclosed brackets exclusively on load-bearing parts of buildings (solid construction).
- In the case of other mountings, use correspondingly suitable mounting techniques. If in doubt, ask your specialist dealer. Otherwise, you endanger yourself and others.
- Use the device in private kitchens only.

Avoiding dangers due to electric shock

- Have work on the voltage supply carried out by a qualified, trained specialist electrician only. At the very least, the specialist electrician must have the following knowledge and skills:
 - Basics of electrical engineering
 - Knowledge of the country-specific regulations and standards (in Germany e.g. DIN 57100/VDE 0100, Part 701)
 - Knowledge of the relevant safety regulations
 - Knowledge of the relevant legal regulations for gas installations (in Germany e.g. the technical regulations for gas installations TRGI).
- Only use the device if it is connected and fused according to the technical data.
- Do not kink or crush the mains cable.
- Do not operate the device with a damaged electrical connection cable.
- Disconnect the device from the current supply in the event of malfunctions.
- The mains plug must be freely accessible so that the device can be easily and quickly disconnected from the mains power supply in an emergency. If the mains plug is inaccessible following installation, an all-pole isolating device with a contact opening of at least 3 mm must be provided in the installation.
- If the device is brought into a warm environment from a cold environment, moisture may form inside the device. In this case, wait for approximately two to three hours before starting up the device.
- Avoid exposing the device to dripping or splashing water. Never place objects filled with fluids, such as e.g. vases, on the device.
- Keep the device dry.
- If fluid nevertheless enters the device:
 - Immediately shut off the current supply by removing the fuse.
 - Make sure that the device's current supply cannot be unintentionally reactivated. E.g.

designate a person to prevent the fuse from being switched on.

- Allow the device to dry.
- Have the device checked and repaired by trained, specialist personnel before using the device again.

Avoiding risk of explosion

- Do not operate the device in an explosive environment.

Avoiding fire hazard

- Make sure that the cooker top has cooled down before covering it.

A soiled device may cause fire hazards.

- Keep the device in flawless condition and check it regularly.
- Regularly remove any grease residues which are present. Grease residues pose a fire hazard.
- Do not flambé beneath the device. Naked flames may e.g. damage neighbouring cupboards.
- Only have repair work on the device carried out by personnel trained for this purpose.

In recirculated air mode:

- A covered or sealed ventilation outlet may cause fire hazards. Do not place any objects such as e.g. cloths or plates on or in front of the device's ventilation slits. In the case of recirculated air devices, outflowing air must be able to escape back into the kitchen through the ventilation slits without impediments.
- No objects which may impede the air flow may be installed above the device. Make sure that the outflowing air is able to flow into the kitchen without impediments.

The device may only be installed above a fireplace for solid fuels (e.g. coal-fired stove) if:

- the fireplace has a sealed cover which cannot be removed. Otherwise, e.g. there is an increased fire hazard due to flying sparks.
- the legal and country-specific regulations are adhered to.

Avoiding risks of injury

- In order to prevent the risk of falling, use a stable stepladder for all work on the device, such as e.g. replacing the filter, installing and cleaning the device.
- In order to prevent risks of injury due to falling parts, use suitable mounting material.
- In order to prevent cuts due to broken glass, use suitable protective gloves.

Avoiding the risk of suffocation

If the device and an open fireplace which is dependent on the room air are operated simultaneously, gases or waste gases may be drawn into the room.

- Make sure that all of the permits required for operation in your country are available (e.g. those of the master chimney sweep).
- Make sure that all standards and guidelines for operating the device in your country are observed.
- Ensure an adequate fresh air supply in the dwelling.
- Do not allow children to play with film or other parts of the packaging.
- Store film or other parts of the packaging in a location which is inaccessible to children.

Preventing the risk of collapse

- The necessary wall passage must be created by a specialist company. Wall passages influence the building's statics. Improperly created wall passages may lead to the collapse of the building.

Avoiding environmental damage

- Dispose of the device and its accessories according to the legal regulations.

Structural features of the information on dangers

The following categories of information on dangers are contained in these instructions:



DANGER

Notices containing the word DANGER warn of a hazardous situation which leads to death or severe injuries.



WARNING

Notices containing the word WARNING warn of a hazardous situation which may lead to death or severe injuries.



CAUTION

Notices containing the word CAUTION warn of a situation which may lead to slight or moderate injuries.

Structural features of notices regarding material or environmental damage

ATTENTION

These notices warn of a situation which leads to material or environmental damage.

Description

- i** The following illustrations show the way in which the possible operating modes function. The devices which are used are shown as symbols. The illustrations are intended to provide assistance. The device forms which are shown may deviate from your devices.

The device can be used to extract and clean cooking vapours.

Possible operating modes

The device is able to operate in various operating modes:

- Recirculated air mode
- Air extraction mode
- Hybrid mode

The individual operating modes are described in the following sections.

Recirculated air mode

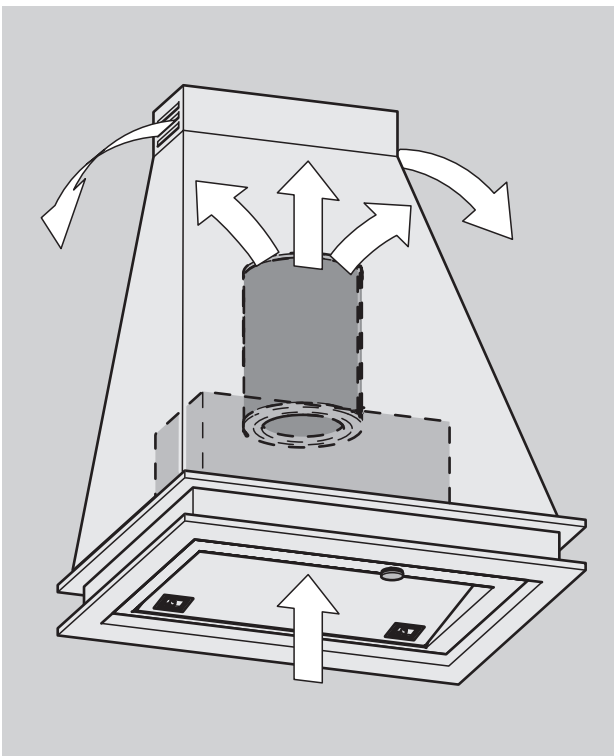

The device intakes room air, filters the room air and returns the cleaned room air into the room.

Cleaning is carried out in several cleaning stages. The majority of the particles of dirt such as e.g. the grease and oil particles from the intaken room air are collected in the lower grease tray. The filter filling in the recirculating air filter neutralises existing odour contents. The odour-free, cleaned room air is returned into the room.

- i** The filter filling must be replaced at regular intervals.

Air extraction mode

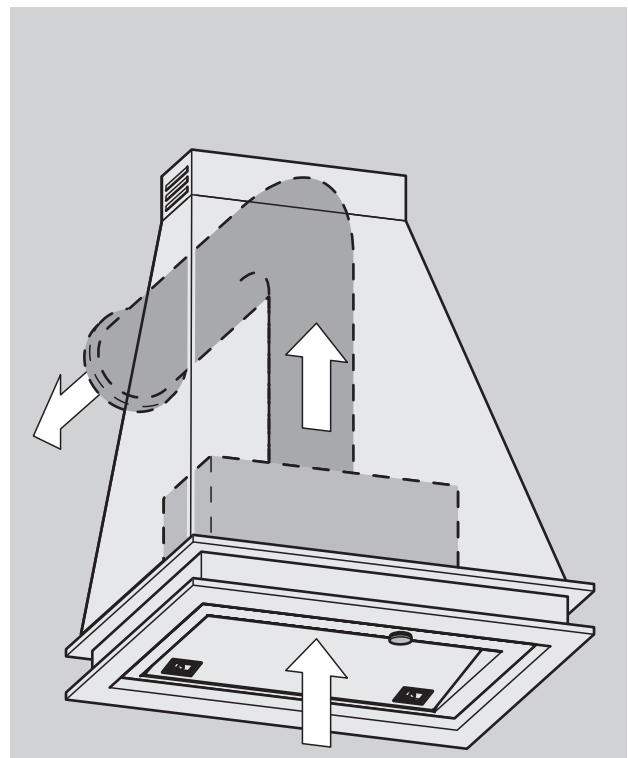

The device intakes room air, filters the room air and conducts the cleaned room air outside. Cleaning is carried out in several cleaning stages. The first cleaning stage removes e.g. grease and air particles from the intaken room air. The next cleaning stage filters light, flying particles (e.g. fluff) from the intaken room air. The cleaned room air is conducted into the open air.

Hybrid mode

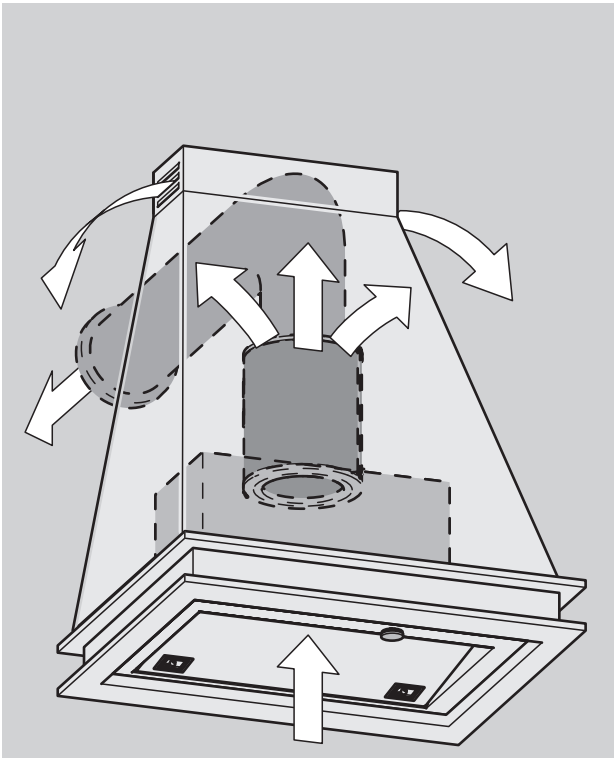

The device intakes room air, cleans the room air and conducts part of the cleaned room air outside. The remaining part of the intaken air is conducted back into the room via the hybrid filter. Cleaning is carried out in several cleaning stages. The majority of the particles of dirt such as e.g. the

grease and oil particles from the intaken room air are collected in the lower grease tray. Whilst part of the cleaned room air is conducted outside, the filter filling in the hybrid filter neutralises odour contents which are present in the remainder of the intaken room air. This odour-free, cleaned room air is returned into the room.

- ⓘ The filter filling must be replaced at regular intervals.

View of the device with flap closed

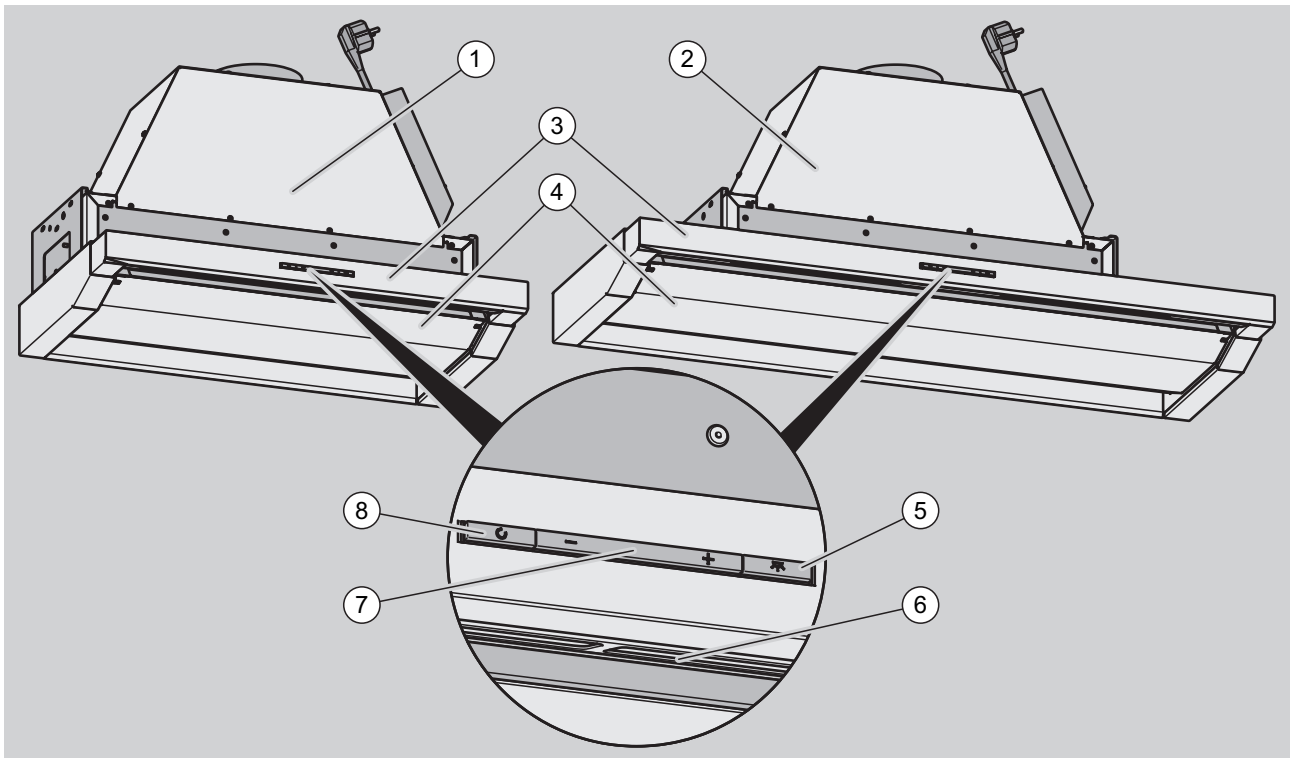

- | | |
|-------------------------------|------------------------------|
| ① Built-in hood BEH 60 FL | ⑤ Lighting ON/OFF button |
| ② Built-in hood BEH 90 FL | ⑥ Lighting |
| ③ Extension | ⑦ Change output level button |
| ④ Flap with lower grease tray | ⑧ Switch on run-on button |

View of the device with flap open

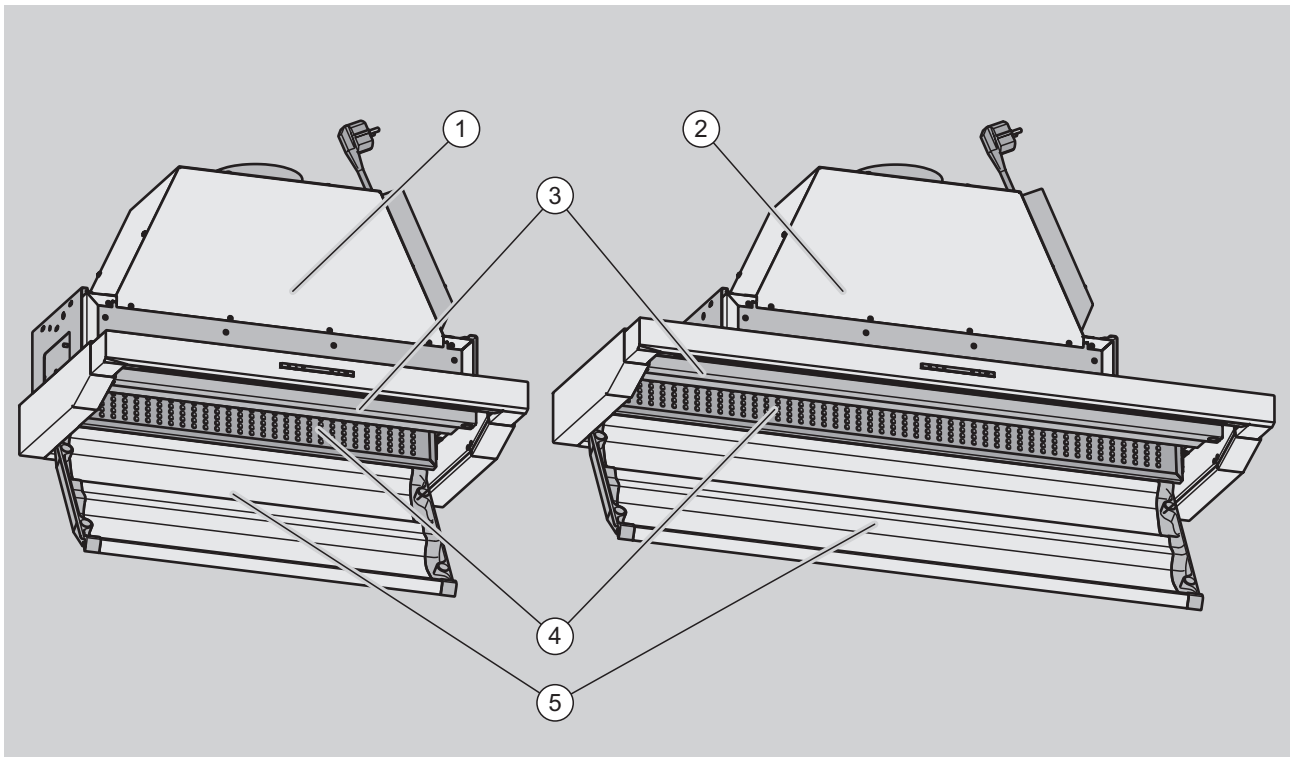

① Built-in hood BEH 60 FL

② Built-in hood BEH 90 FL

③ Upper grease tray

④ "Capillar Trap"

⑤ Flap with lower grease tray

ⓘ The following descriptions are identical for built-in hoods BEH 60 FL and BEH 90 FL. BEH 60 FL is shown in the illustrations.

Operation with the button panel

To operate the FLT version, see *Operation with the Sensor-Touch control panel page 16*.



WARNING

Danger of suffocation due to a lack of oxygen on operation of the device.

- Ensure an adequate fresh air supply in the dwelling.
- Make sure that the device is connected to a window contact switch to ensure hazard-free operation.
- Make sure that the country-specific, legally prescribed regulations (in Germany e.g. the requirements of your Federal state's regulations pertaining to fireplaces (FeuV)) are adhered to.

The device is equipped with a button panel for operation. The button panel has three buttons.

The button panel is located centrally on the front side of the device.

The following sections provide information on how to control the functions of the device using the button panel.

Switching on the ventilation function



WARNING

Danger of burning due to flambéing beneath the device.

Naked flames may e.g. cause burns on the skin.

- Do not flambé beneath the device.

ATTENTION

Fire hazard due to flambéing beneath the device.

Naked flames may e.g. damage neighbouring cupboards.

- Do not flambé beneath the device.

- ⓘ ➤ Replace the filter's filling if you switch the device on and determine an unpleasant odour.

See Cleaning from page 20.

Clean the device if you switch the device on and determine increased fan noise.

See Cleaning from page 20.

- ⓘ After six hours of continuous operation without the actuation of any controls, the device automatically shuts ventilation mode off.
 - If necessary, switch the device on again.

Cooking vapours are best eradicated if you

- switch the device on at the start of cooking
- switch the device's run-on function on at the end of cooking.

The ventilation system can be operated at three different output levels.

Three LEDs are installed above and below the button for switching the output level. The output level which is switched on can be recognised by the corresponding number of illuminated LEDs.

Proceed as follows to switch on the device's ventilation function:

➤ Press the "+" button once.

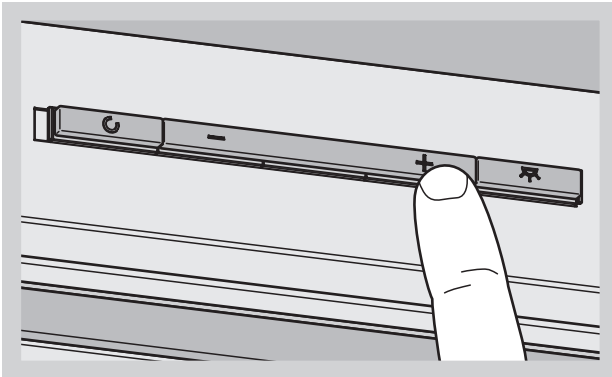

The device operates at output level "1".

The relevant LED lights up.

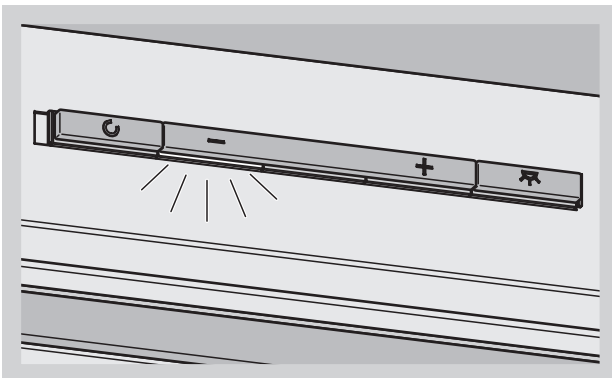

Changing the output level

Increasing the output

During operation, the device can be switched to a higher output level at any time.

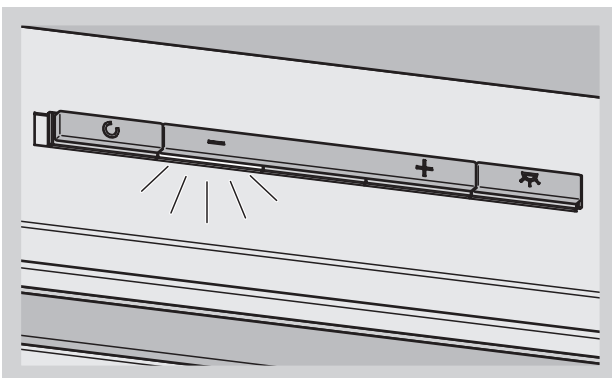

➤ Press the "+" button.

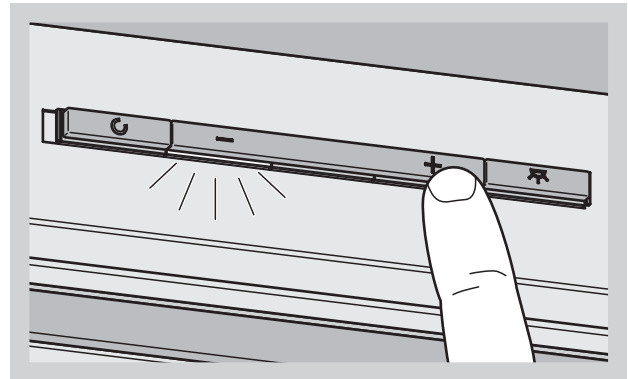

The device operates at the next higher output level.

The relevant LEDs light up.

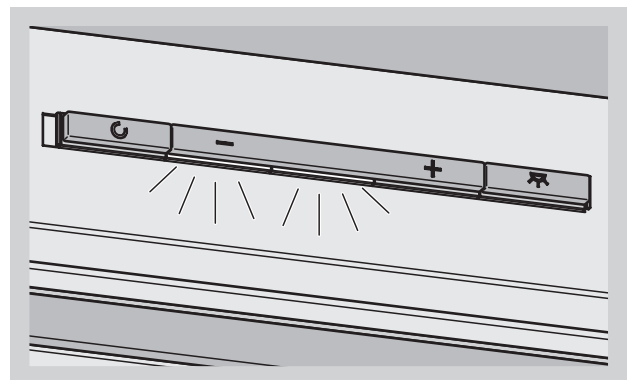

Reducing the output

During operation, the device can be switched to a lower output level at any time.

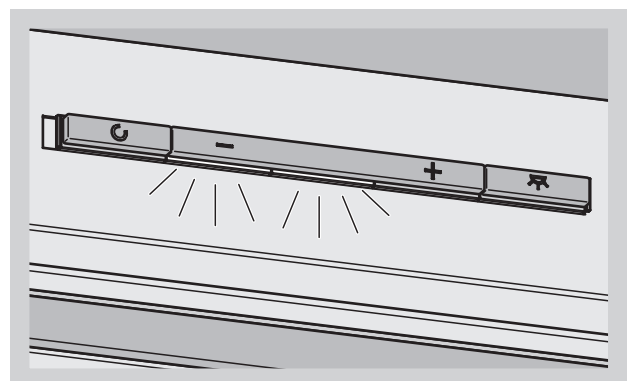

➤ Press the "-" button.

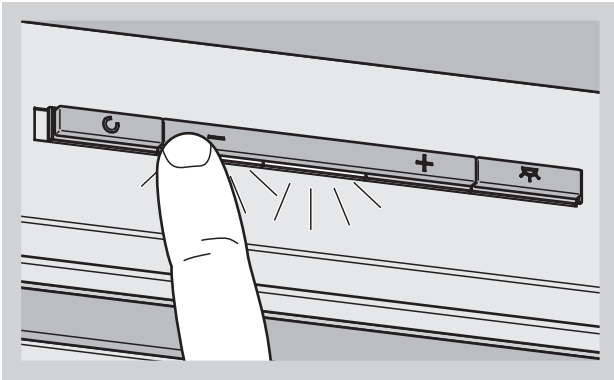

The device operates at the next lower output level.

The relevant LED lights up.

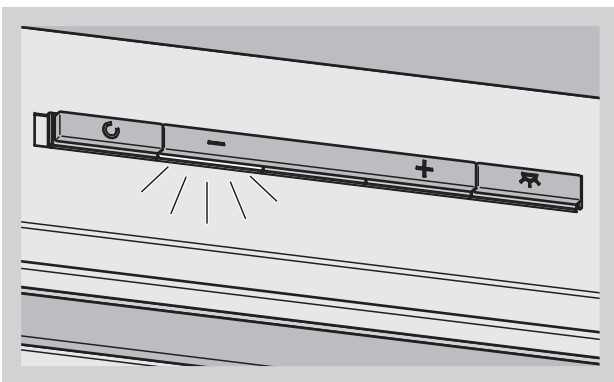

Switching off the ventilation function

Proceed as follows to switch off the ventilation function:

- Press the "-" button until the ventilation system switches off.

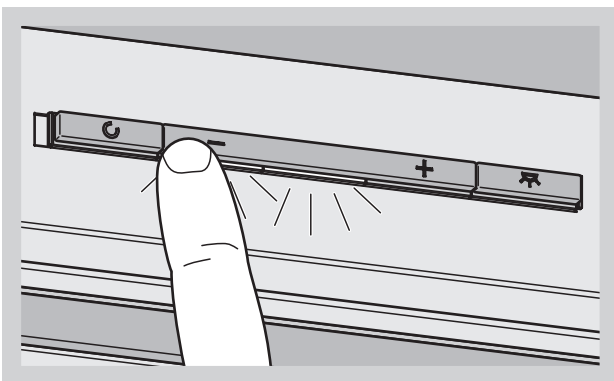

The device switches the ventilation function off.

The LEDs do not light up.

Switching the run-on function on and off

The device is equipped with a run-on function.

When this function is used, the device continues to operate at output level 2 for ten minutes and then switches the ventilation function off automatically.

- Press the left-hand button to switch the run-on function on.

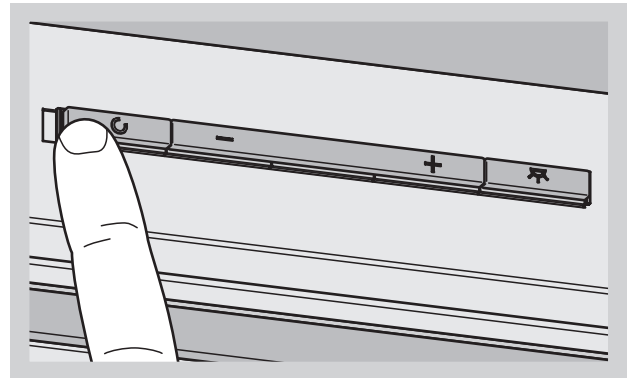

The run-on function is switched on.

The device operates at output level 2 and switches off after ten minutes.

Whilst the run-on function is active, the LEDs for output levels 1 and 2 flash.

- Press the left-hand button again to switch the run-on function off.

Switching the lighting on and off

In order to illuminate the cooker top, the device is equipped with energy-saving LED lighting.

The lighting can be used independently from the fan.

Switching on the lighting

- Press the right-hand button to switch the lighting on.

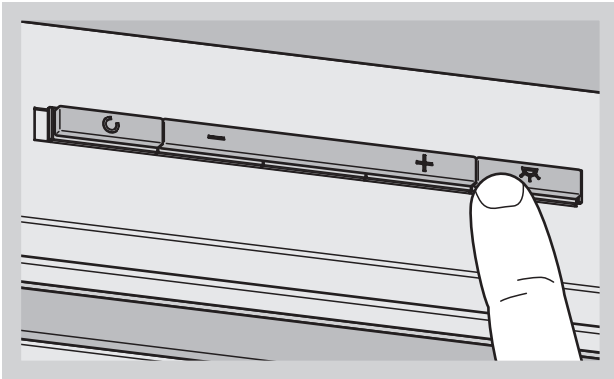

The lighting is switched on.

Switching off the lighting

- Press the right-hand button again to switch the lighting off.

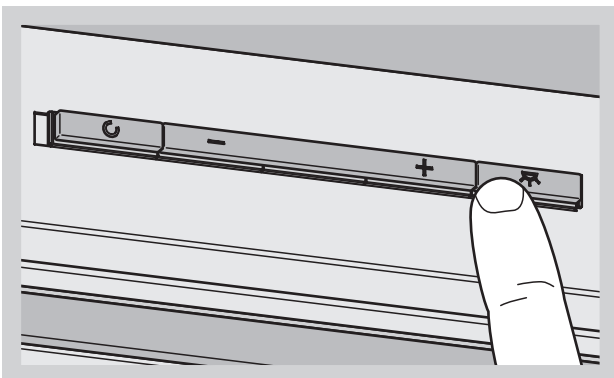

The lighting is switched off.

Using the extension

The device is equipped with an extension. The device's intake area is increased when the extension is opened. Cooking vapours in the front part of the cooking area are intaken better.

Opening the extension

Proceed as follows to open the extension:

- Grip beneath the front panel.
- Pull the extension forwards to stop.

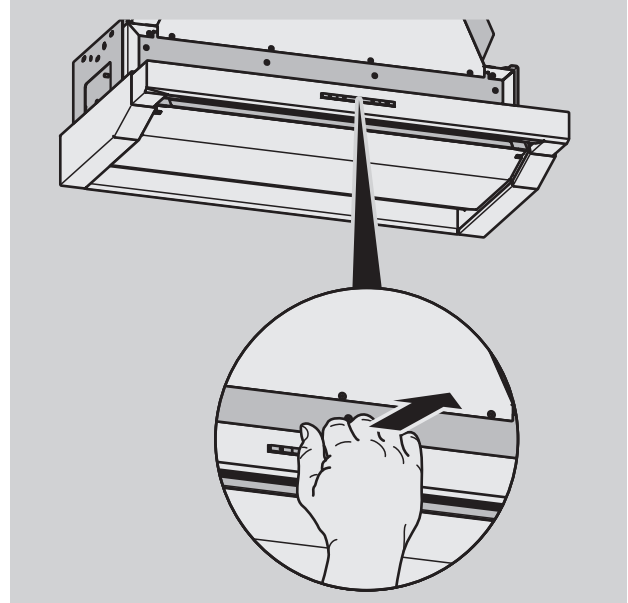

Inserting the extension

Proceed as follows to insert the extension:

- Push the extension backwards into the device to stop at the front panel.

The extension is closed.

Operation with the Sensor-Touch control panel

To operate the FL version, see *Operation with the button panel page 12.*



WARNING

Danger of suffocation due to a lack of oxygen on operation of the device.

- Ensure an adequate fresh air supply in the dwelling.
- Make sure that the device is connected to a window contact switch to ensure hazard-free operation.
- Make sure that the country-specific, legally prescribed regulations (in Germany e.g. the requirements of your Federal state's regulations pertaining to fireplaces (FeuV)) are adhered to.

The extractor hood is equipped with a Sensor-Touch control panel. The control panel is located on the front side of the extractor hood.

- In order to actuate the desired function, touch the corresponding touch fields with your finger.

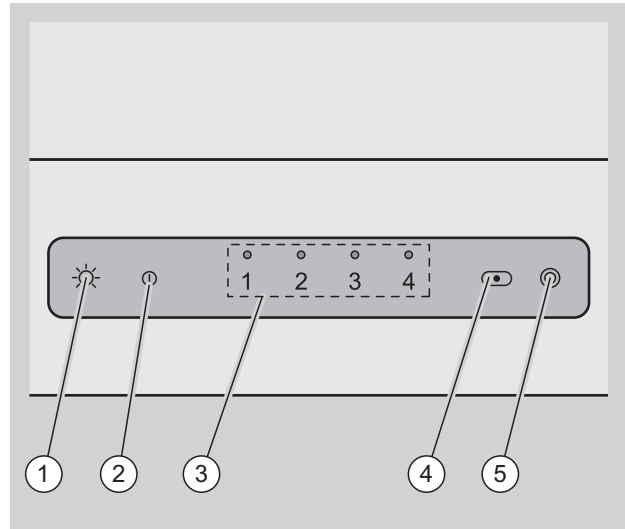

- ① Lighting ON/OFF touch field
- ② Device OFF touch field
Manual run-on function ON/OFF
Configuration mode ON/OFF
- ③ Output level 1-4 touch fields and LEDs
- ④ Clean "Capillar Trap" display
- ⑤ Replace recirculating air filter/filling display

Switching on the ventilation function



WARNING

Danger of burning due to flambéing beneath the device.

Naked flames may e.g. cause burns on the skin.

- Do not flambé beneath the device.

ATTENTION

Fire hazard due to flambéing beneath the device.

Naked flames may e.g. damage neighbouring cupboards.

- Do not flambé beneath the device.

- **i** Replace the filter's filling if you switch the device on and determine an unpleasant odour.

See Cleaning from page 20.

Clean the device if you switch the device on and determine increased fan noise.

See Cleaning from page 20.

- **i** After six hours of continuous operation without the actuation of any controls, the device automatically shuts ventilation mode off.
- If necessary, switch the device on again.

Cooking vapours are best eradicated if you

- switch the device on at the start of cooking
- switch the device's run-on function on at the end of cooking.

- Touch one of the touch fields (3) to switch the device on.

The device operates at the selected output level.

The relevant LED lights up.

Changing the output level

- In order to switch the output level, touch the corresponding touch field.

The device operates at the selected output level.

The relevant LED lights up.

Switching off the ventilation function

- Touch the touch field (2) to switch the device off.

No LED lights up.

If the run-on function has been switched on in the settings, the device continues to run at the last output level selected for a further ten minutes. The device then switches the ventilation function off.

Switching the run-on function on and off

Manual

The device is equipped with a run-on function. If this function is used, the device continues to operate at the last output level selected for a further ten minutes. The device then switches the ventilation function off.

- In order to switch the run-on function on, touch the touch field (2) twice in succession during operation.

The LED for the corresponding output level flashes.

- In order to switch the run-on function off, touch the touch field again.

No LED lights up.

Automatic

The device can be set in such a way that the run-on function is automatically switched on when the device is switched off.

See page 19.

- In order to switch off the automatically switched on run-on function, touch the touch field (2).

Switching the lighting on and off

In order to illuminate the cooker top, the device is equipped with energy-saving LED lighting.

The lighting can be used independently from the fan.

- In order to switch the illumination on, touch the touch field (1).

- In order to switch the illumination off, touch the touch field (1) again.

Displays

The displays on the control panel remind you to carry out certain maintenance work.

Cleaning the "Capillar Trap"

This display (4) flashes every 20 hours of operation.

- Clean the "Capillar Trap".

See page 20.

- In order to reset the display, switch the device off and on again.

Replacing the recirculating air filter/filling

This display (5) flashes every 350 hours of operation when the device is used in recirculated air mode.

- Replace the recirculating air filter/filling.

See page 24

Proceed as follows to reset the display after replacing:

- Touch the touch field (2) for longer than ten seconds.

The four LEDs light up briefly five times.

- Touch the touch field for output level 3.

The display for recirculating air filter/filling replacement no longer lights up.

- Briefly touch the touch field (2).

The four LEDs light up briefly.

The settings are saved. The device is ready to operate again.

Carrying out settings

The following basic settings can be carried out in configuration mode:

- Switching the signal sound for the touch fields on and off
- Switching recirculated air mode on and off
- Resetting the replace recirculating air filter/filling display
- Switching the automatic run-on function on and off

Switching configuration mode on and off

Proceed as follows to switch configuration mode on:

- Make sure that the device is switched off.
- Touch the touch field (2) for longer than ten seconds.

The four LEDs light up briefly five times.

- Carry out the desired settings.

Proceed as follows to switch configuration mode off:

- Briefly touch the touch field (2).

The four LEDs light up briefly.

The settings are saved. The device is ready to operate again.

Switching the signal sound for the touch fields on and off

If the signal sound for touch fields is switched on, a signal sound is heard each time a touch field is touched. The signal sound for touch fields is switched off on delivery.

Proceed as follows to switch the signal sound for touch fields on:

- Switch configuration mode on.
- Touch the touch field for output level 1.

The corresponding LED lights up.

- Switch configuration mode off.

Proceed as follows to switch the signal sound for touch fields off:

- Switch configuration mode on.
- Touch the touch field for output level 1.

The corresponding LED does not light up.

- Switch configuration mode off.

Switching recirculated air mode on and off

Recirculated air mode is switched off on delivery.

Proceed as follows to switch recirculated air mode on:

- Switch configuration mode on.
- Touch the touch field for output level 2.
- The corresponding LED lights up.
- Switch configuration mode off.

Proceed as follows to switch recirculated air mode off:

- Switch configuration mode on.
 - Touch the touch field for output level 2.
- The corresponding LED does not light up.
- Switch configuration mode off.

Switching the replace recirculating air filter/filling display off

Proceed as follows to switch the display off after replacing:

- Switch configuration mode on.
- Touch the touch field for output level 3.

The display for recirculating air filter/filling replacement no longer lights up.

- Switch configuration mode off.

Switching the automatic run-on function on and off

When the automatic run-on function is switched on, the device continues to run at the last output level selected for a further ten minutes. The device then switches the ventilation function off. The automatic run-on function is switched off on delivery.

Proceed as follows to switch on the automatic run-on function:

- Switch configuration mode on.
- Touch the touch field for output level 4.

The corresponding LED lights up.

- Switch configuration mode off.

Proceed as follows to switch off the automatic run-on function:

- Switch configuration mode on.
- Touch the touch field for output level 4.

The corresponding LED does not light up.

- Switch configuration mode off.

Cleaning



DANGER

Fatal electric shock due to fluids which enter the device.

- Never pour fluids into the device.



WARNING

Fire hazard due to grease residues in and on the device.

- Clean the device regularly.

ATTENTION

Damage to surfaces due to sharp-edged objects or aggressive cleaning agents.

- Never use sharp-edged objects, scouring agents or aggressive cleaning agents.
- Use a soft, moist cloth.

Cleaning intervals

Usage behaviour	Time period
Little or occasional use.	Each time after cooking. <i>See Cleaning in the case of normal soiling on page 20.</i>
Daily or extensive use.	After 3 weeks at the latest. <i>See Cleaning in the case of severe soiling on page 20.</i>

Cleaning in the case of normal soiling

The device is designed in such a way that the foreign particles contained in the intaken room air are separated and collected in the grease trays.

Proceed as follows to clean the device in the case of normal soiling:

- Open the flap by pulling it downwards at the rounded edge.

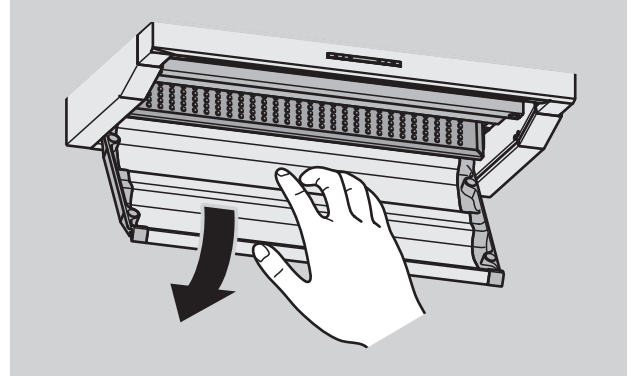

- Use a soft, moist cloth or kitchen roll for cleaning.
- Wipe the grease trays off.

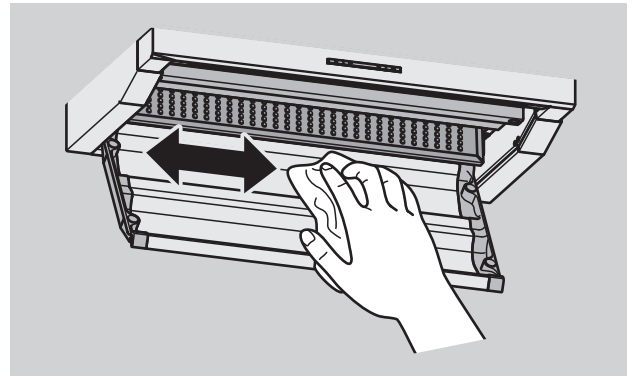

Closing the lower flap

- Close the flap by pressing it up until both retaining magnets audibly make contact.

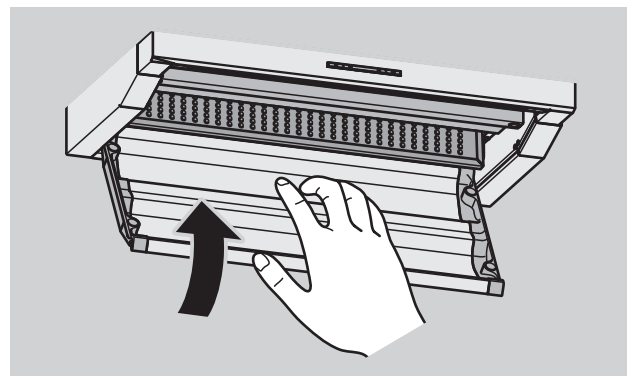

Cleaning in the case of severe soiling

If the device is severely soiled, the grease trays and the "Capillar Trap" must be removed. These parts

can be easily removed and installed and can be reused after cleaning.

Proceed as follows to clean the device in the case of severe soiling:

Removing the lower tray (lower grease tray)

- Switch the device off.
- Open the flap by pulling it downwards at the rounded edge.

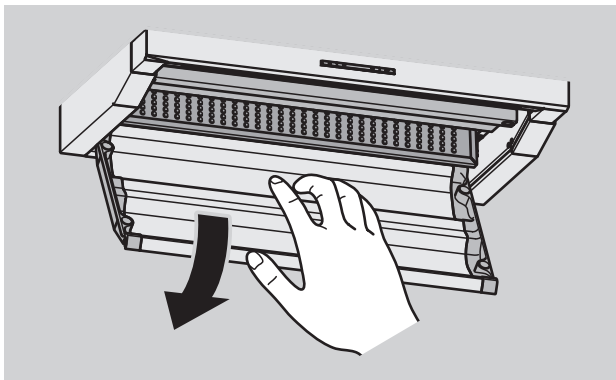

Use a soft, moist cloth or paper for cleaning.

- Wipe the parts off.

- Grip the grease tray, which is folded down vertically, at the sides using both hands.
- Raise the lower grease tray approx. 2 cm (1.).
- Release the lower grease tray by pulling it forwards (2.).

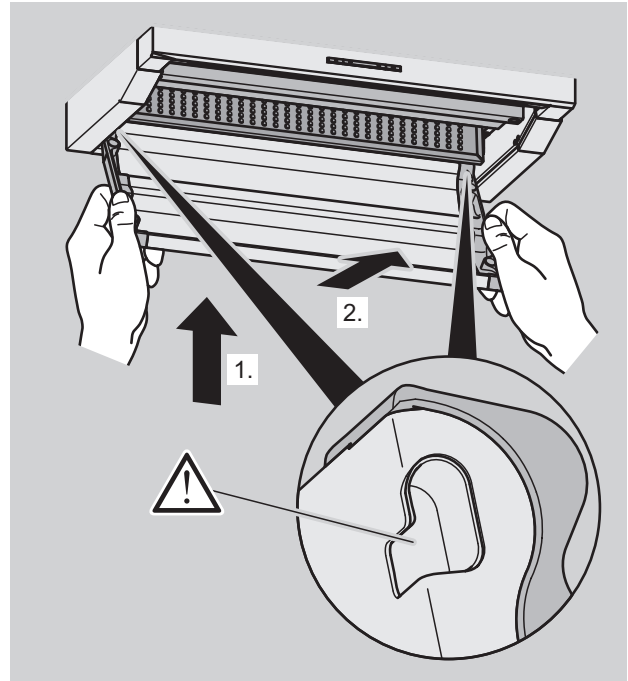

- Remove the lower grease tray.

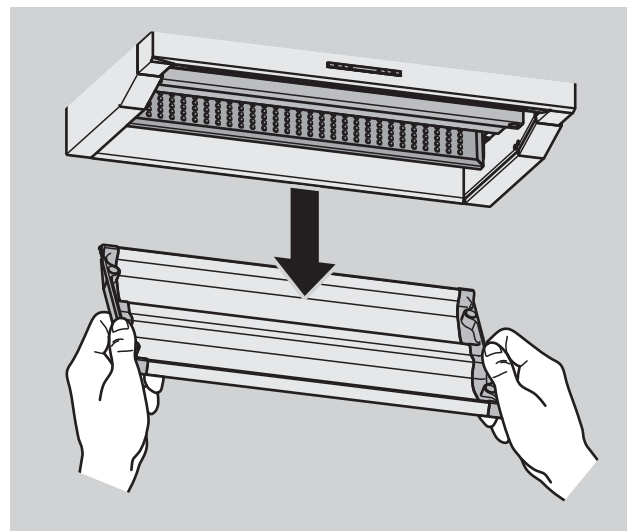

Removing the "Capillar Trap"

- Grip the "Capillar Trap" at the sides.
- Pull the "Capillar Trap" off downwards.

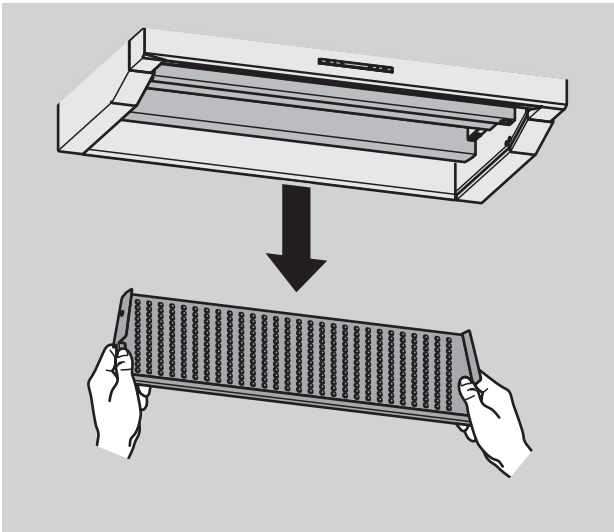

- Insert the "Capillar Trap" into the device by pressing it firmly upwards.

The "Capillar Trap" does not engage; instead, it is merely clamped in.

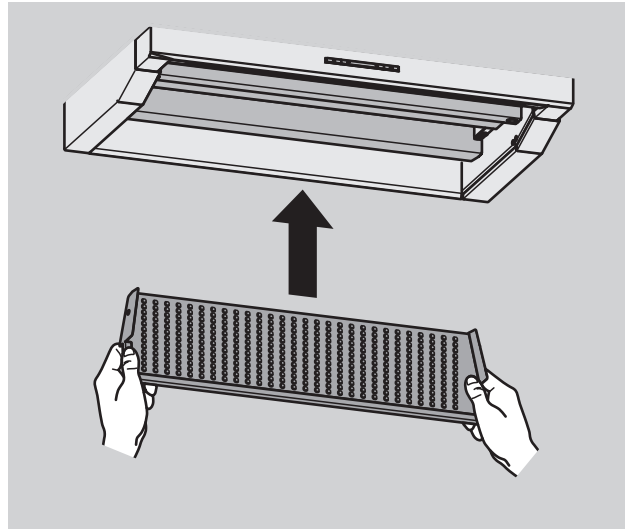

Cleaning parts

- Clean the lower grease tray e.g. with a moist cloth.
- Clean the remaining parts, e.g. in the dishwasher.
- Clean the upper grease tray e.g. with a moist cloth.
- Clean the four surfaces of the "Capillar Trap" mounting shaft e.g. using a moist cloth.
- Clean the two edges above the "Capillar Trap" mounting shaft e.g. using a moist cloth.

After cleaning, insert the cleaned parts as follows:

Installing the "Capillar Trap"

- Make sure that the "Capillar Trap" is completely dry before inserting.

Installing the lower grease tray

- Grip the grease tray using both hands.
- Guide the flap into the device from below until the flap guide grooves are simultaneously positioned in front of the device's guide pins.

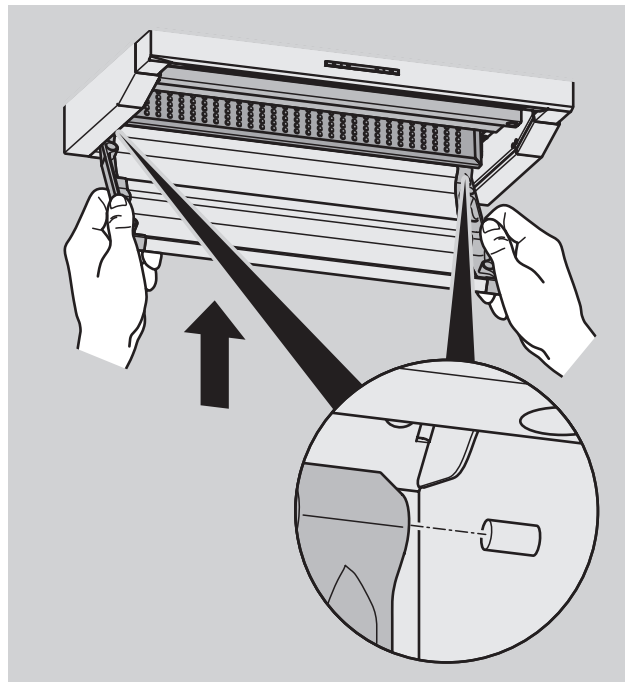

- Press the grease tray backwards into the device (1.).
- Pull the grease tray downwards (2.) until it engages.
- Make sure that the grease tray is inserted correctly. The grease tray is correctly inserted when the flap can be moved easily.

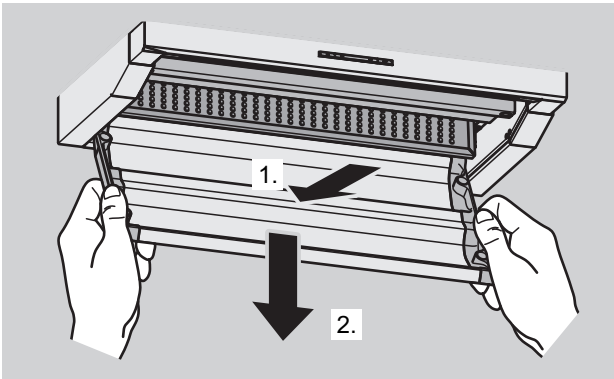

- Clean surfaces with a soft, moist cloth and a mild household cleaning agent.

Closing the lower flap

- Close the flap by pressing it up until both retaining magnets audibly make contact.

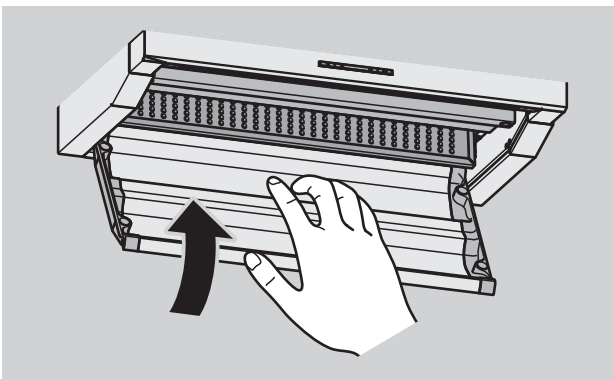

Cleaning surfaces

ATTENTION

Damage to surfaces due to sharp-edged objects or aggressive cleaning agents.

- Never use sharp-edged objects, scouring agents or aggressive cleaning agents.
 - Use a soft, moist cloth.
-

Maintenance

Maintaining the device

The device is maintenance-free.

Replacing the lighting

The device is equipped with LED lighting. The bulbs have a service life of approx. 50,000 hours of operation.

- Contact your specialist berbel dealer or the berbel customer service in the event of malfunctions.

Replacing the filter filling (hybrid and recirculating air filters)

Replace the filter filling in accordance with the specifications in the following table:

Usage behaviour	Time period
Little or occasional use	In the case of odours in the outgoing air, after 24 months at the latest
Daily or extensive use	In the case of odours in the outgoing air, after 12 months at the latest



WARNING

Risk of falling when replacing filter.

- Use a stable stepladder.



WARNING

Risk of injury due to falling parts.

- Make sure that nobody is standing beneath the working area during work.

ATTENTION

Damage due to falling parts.

- Protect surfaces and devices (e.g. cooled cooker top) beneath your working area from damage, e.g. with thick cardboard.

ⓘ Nothing may be installed above the device, as replacement of the filter filling is otherwise impossible.

- Remove all coverings and other surroundings. The filter must be freely accessible.

The filter is freely accessible.

Removing the hybrid filter

Proceed as follows to replace the filter filling:

- Remove the outgoing air line from the fan housing
- Pull the filter out upwards.

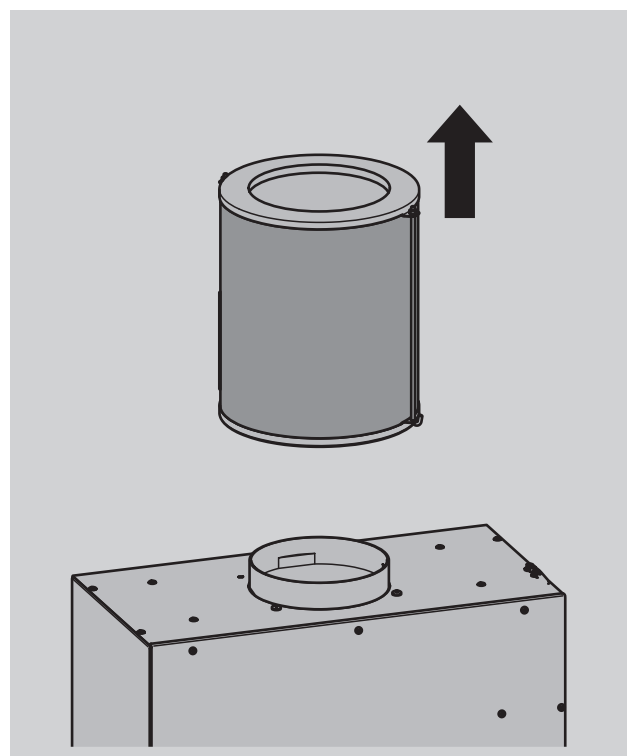

Removing the recirculating air filter

Proceed as follows to replace the filter filling:

- Pull the filter out upwards using the folding handle.

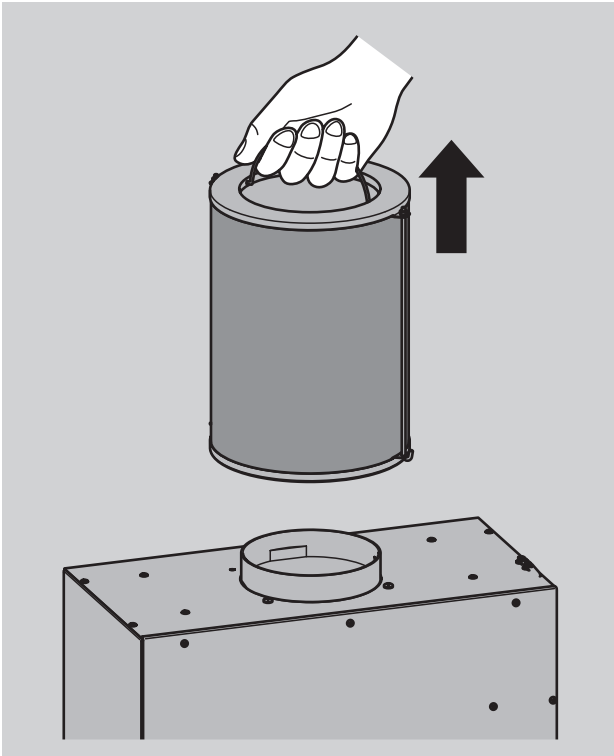

Replacing the filter filling

- ① Replacement of the filter filling is described separately in the operating instructions for the filter filling.

- Replace the filter filling.

Installing the filter

- ① To ensure that the filter is installed correctly, an approx. two centimetre-high guide aid is installed on the seat of the filter.

- Position the filter on the device from above.

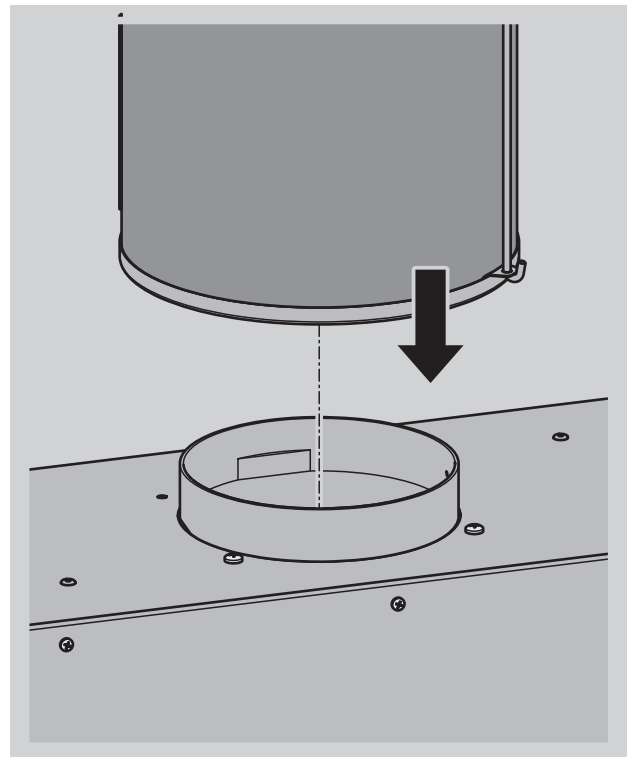

The filter is correctly inserted when the lower edge lies fully on the device.

- Make sure that the filter is inserted correctly.

The filter is installed correctly. If the filter is not installed correctly, proceed as follows:

- Remove the filter.
- Position the filter again.

Hybrid mode only:

- Slide the outgoing air line into the filter.

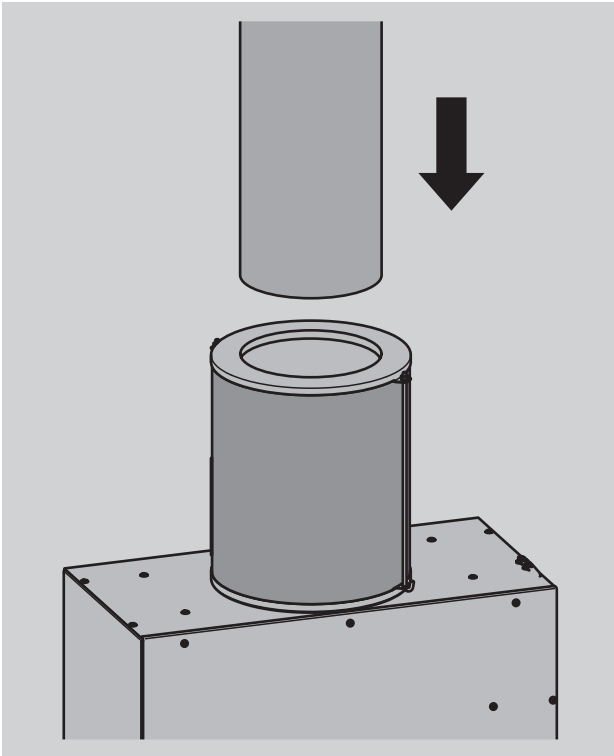

- Mask the transition between the outgoing air line and the guide aid with sealing tape.
- Make sure that the outgoing air line is correctly connected.
- Install the coverings or other surroundings.

Rectifying malfunctions



DANGER

Fatal electric shock due to improperly carried out repairs.

- Make sure that repairs are carried out exclusively by the manufacturer or authorised specialists.

Malfunction	Possible cause	Remedy
Blower and lighting do not function.	No current supply.	Check whether the mains plug is connected. Connect the mains plug.
	The fuse has triggered or is defective.	Check whether the fuse has triggered. If you have a power circuit breaker, switch the power circuit breaker on. Contact a specialist electrician in the case of other fuse types.
Blower does not function.	The extractor hood is not switched on.	Check all possible output levels. <i>See Switching on the ventilation function on page 12.</i>
	The extractor hood is connected to a window switch and the window is closed.	Open the window.
Lighting does not function.	The bulb is defective.	Contact your specialist berbel dealer.
Odour formation during operation.	The hybrid filter filling is spent.	Replace the hybrid filter filling. <i>See Replacing the filter filling (hybrid and recirculating air filters) on page 24.</i>

Malfunction	Possible cause	Remedy
Poor extractor hood output.	The recirculating air filter has become clogged.	Replace the filter filling in the recirculating air filter. <i>See Replacing the filter filling (hybrid and recirculating air filters) on page 24.</i>
	The hybrid filter is clogged.	Replace the filter filling in the hybrid filter. <i>See Replacing the filter filling (hybrid and recirculating air filters) on page 24.</i>
	The outgoing air line has not been connected or routed properly.	Contact your specialist berbel dealer or the berbel customer service.

➤ If a malfunction cannot be rectified, contact your specialist berbel dealer or the berbel customer service.

Disposal

Disposing of packaging



DANGER

Danger of suffocation due to parts of the packaging (e.g. films and polystyrene).

- Store film or other parts of the packaging in a location which is inaccessible to children.

ATTENTION

Environmental damage due to improper disposal of the packaging.

- Never dispose of the packaging in the normal domestic refuse.
- Have the packaging properly recycled in an environmentally-friendly manner.



The packaging offers protection against transportation damage.

Only the original packaging guarantees adequate protection during transportation.

- Retain the packaging during the warranty period.

The packaging materials have been selected according to environmental compatibility aspects and are manufactured from recyclable materials. After use, the packaging materials can be recycled. Valuable raw materials can therefore be saved.

- The exterior packaging consists of cardboard.
- The filler material and the inserts consist of cardboard or polystyrene.
- The protective films and bags consist of polyethylene (PE).

- Dispose of the packaging according to material segregation and in an environmentally-friendly manner.

deviceDisposal



ATTENTION

Environmental damage due to improper disposal of electronic components.

- Never dispose of the device in the normal domestic refuse at the end of its useful life.
- Ask your municipal or local administration about options for recycling or disposing of the device in a proper and environmentally-friendly manner.

- Dispose of the device according to the legal regulations via a specialist disposal company.

Technical data

Model plate

The model plate can be found inside the device behind the lower grease tray flap.

The model plate contains the following information:

- Manufacturer
- Manufacturer's address
- Device type
- Voltage
- Total output
- Serial number
- Year of construction
- Symbols of the legal regulations to which the device adheres and test symbols.

Built-in hood BEH 60 FL/FLT

Width	599 mm
Depth	330 mm
Height	363 mm
Max. fan output, free-blowing	1 fan with 600 m ³ /h
Weight (air extraction mode)	Approx. 15 kg
Weight (recirculated air mode)	Approx. 15 kg (without corresponding filter)
Power consumption	162 W (at highest output level)
LED bulb	24 V/6 W

Built-in hood BEH 90 FL/FLT

Width	899 mm
Depth	330 mm
Height	363 mm
Max. fan output, free-blowing	1 fan with 600 m ³ /h
Weight (air extraction mode)	Approx. 18 kg
Weight (recirculated air mode)	Approx. 18 kg (without corresponding filter)
Power consumption	163 W (at highest output level)
LED bulb	24 V/7 W

The device has been manufactured under adherence to the regulations of VDE 60335-2-31 and complies with the following directives and laws:

- EMC Directive (EU Directive 2004/108/EEC)
- Low-voltage Directive (2006/95/EU).

We reserve the right to implement technical changes.

Contacting the manufacturer

If you have any questions which are not answered by these instructions, contact:

berbel Ablufttechnik GmbH

Sandkampstraße 100

D-48432 Rheine

Telephone +49 (0)800/56 06 06-0*

Fax +49 (0)800/56 06 06-1*

Internet www.berbel.de

*) Free from the German land line

© KONTECXT GmbH Technische Dokumentation

D-45145 Essen

www.technische-dokumentation.de

Printed in Germany